

Math:



Backyard Graphing

Primary Audience: Grades 3-5,5-7

Description: Use models and pictures to relate concepts of ratio, proportion and percent. Develop common referents for units of measure for length, weight, volume (capacity) and time to make comparisons and estimates.

Keywords: Graphing, Area, Proportion

Concepts:

- Number, Number Sense & Operation Standard 5-7 D
- Measurement 3-5 C.

Materials:

- Pencil
- graph paper

Instructions:

- Using a sheet of graph paper, draw the outline of your backyard, or other chosen plot of land.
- As accurately as possible, fill in all of the major features of your yard, and their approximate size (for example, garage takes up 8 squares)
- The graph holds 100 squares. If you use all hundred for your yard, each square is one percent. What percentage of your yard is taken up by your garage, garden, etc? What is the ratio of man-made vs. natural in your yard? What percentage of your yard is “free space?”

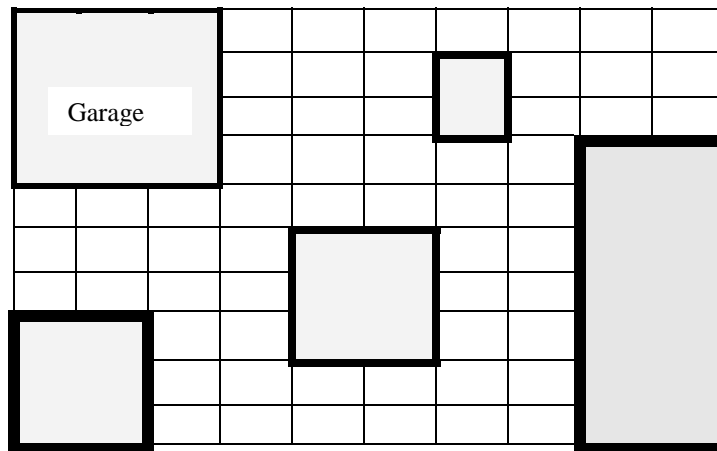

Math:

Backyard Graphing

My _____ takes up _____ squares (_____ %)

My _____ takes up _____ squares (_____ %)

My _____ takes up _____ squares (_____ %)

My _____ takes up _____ squares (_____ %)

Man-made things take up _____ squares (_____ %)

My yard has _____ empty squares (_____ %)

I would like to add _____ to my yard. It would take up _____ squares (_____ %)

Math:

Possible Interactive Questions:

-

What's Going On?

This activity using the skills of measuring, counting, graphing, finding ratios, fractions, percentiles, and making visual interpretations and observations about your surroundings.

Further Exploration:

- 1.

Relevant Ohio Science Content Standards: